

Subject: TCS / DSC WARNING LIGHT ON WITH DTC C1956	Bulletin No: 09-004/08
	Last Issued: 01/22/2008

APPLICABLE MODEL(S)/VINS

2006-2007 Mazdaspeed6 vehicles with VINs lower than JM1GG****7*110516 (produced before June 6, 2007)

DESCRIPTION

Some vehicles may experience a TCS/DSC warning light illumination with DTC C1956 (Steering Angle Sensor) stored in memory.

Depending on the size variation in the production of related combination switch parts on the steering shaft, steering angle sensor parts may come in contact with each other causing debris to attach to the steering angle sensor. The debris can cause abnormal signals resulting in a TCS/DSC warning light illumination.

The steering angle sensor assembly in the combination switch body has been modified to avoid interference. Customers having this concern should have their vehicle repaired using the following repair procedure.

REPAIR PROCEDURE

1. Verify customer concern.
2. Record customer's preset radio stations, then disconnect negative battery cable.
3. Replace combination switch body with a modified part according to Workshop Manual (section 09-18 COMBINATION SWITCH REMOVAL/INSTALLATION).

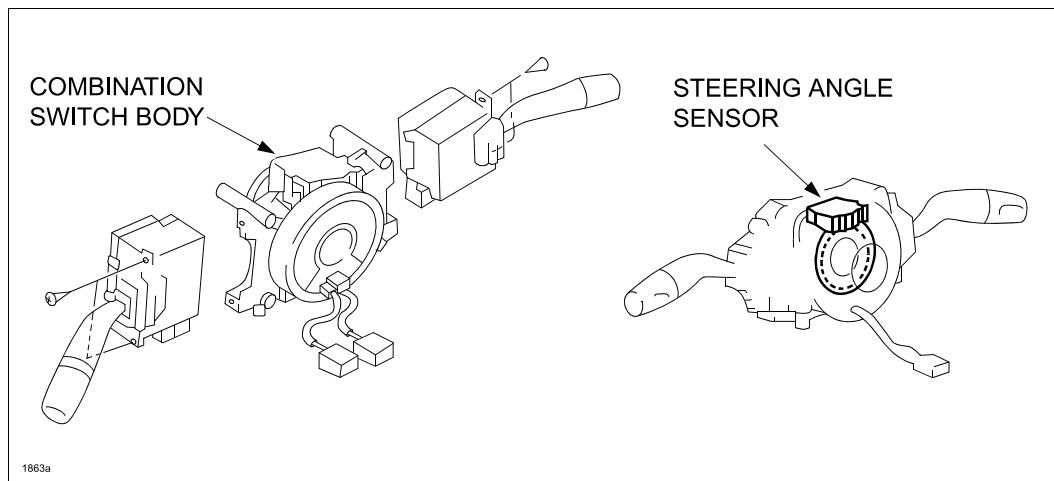

4. Reconnect negative battery cable, then re-enter customer's preset radio stations.
5. Proceed to "Power Window Initialization Procedure" to restore "anti-pinch" and "auto open/close" window features before returning vehicle to customer or dealer inventory.

POWER WINDOW INITIALIZATION PROCEDURE

1. Turn ignition to ON position.
2. From driver's seat ensure window lockout switch is NOT depressed.

POWER WINDOW MAIN SWITCH

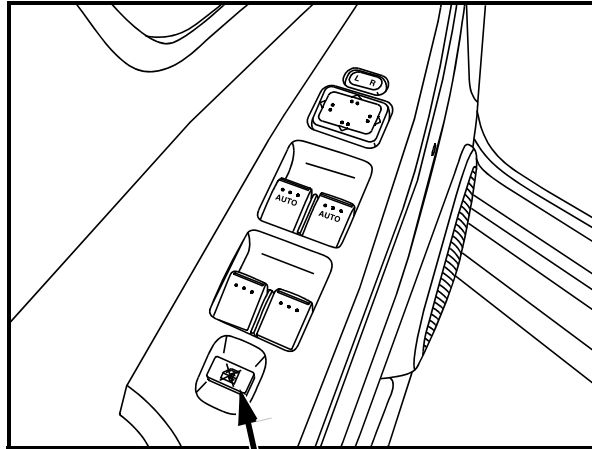

1601a

ENSURE WINDOW LOCKOUT
SWITCH IS NOT DEPRESSED

3. Press window switch down to fully open door window.
4. Pull window switch up to fully close door window; hold switch up for two (2) seconds; release switch.

OPEN WINDOW FULLY, CLOSE WINDOW
FULLY HOLDING SWITCH UP FOR
TWO(2) SECONDS, RELEASE SWITCH

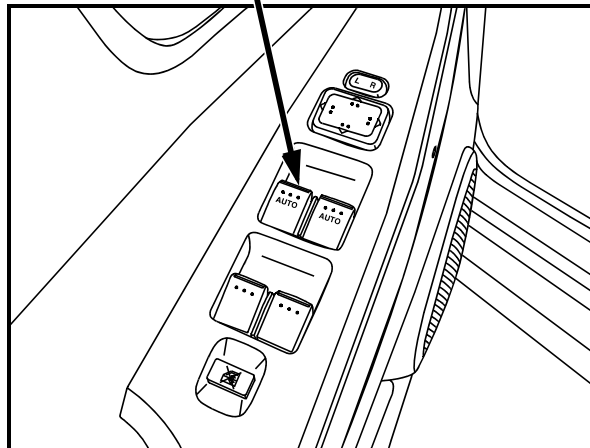

1601b

5. Move to front passenger seat and repeat Steps 3 - 4 on passenger window switch.
6. Move to rear seat and repeat Steps 3 - 4 on both rear window switches.
7. Verify proper window operation using each door switch.

PART(S) INFORMATION

Part Number	Description	Qty.
GJ6E-66-1B1A	Body, Combination Switch	1

WARRANTY INFORMATION

NOTE:

- This warranty information applies only to verified customer complaints on vehicles eligible for warranty repair. Refer to the Warranty Wizard for warranty term information.
- Additional diagnostic time cannot be claimed for this repair.

Warranty Type	A
Symptom Code	64
Damage Code	9C
Part Number Main Cause	GJ6E-66-1B1A
Quantity	1
Operation Number / Labor Hours:	XXC40XRX / 0.6 Hrs.